

SIZE	Ød	L	H	W	ØA	ØB	C	D	ØPCD	Cv	TORQUE
										FACTOR	kgf-cm
1/2"	15	129.2	55	95	45	95	2	14	65	11.2	54
3/4"	20	149.0	58.5	110	58	105	2	16	75	21	74
1"	25	159.0	73	135	68	115	2	16	85	35	104
1-1/4"	32	179.0	78.5	135	78	140	2	16	100	57	135
1-1/2"	38	199.2	90.5	165	88	150	2	16	110	80	180
2"	50	229.0	99	165	102	165	3	18	125	150	250
2-1/2"	65	289.0	127	215	122	185	3	22	145	265	480
3"	80	306.0	136	215	138	200	3	24	160	415	750
4"	100	356.0	172	325	162	235	3	24	190	780	1100

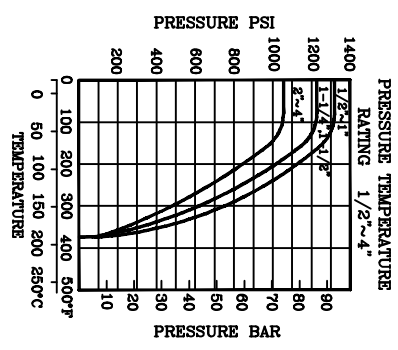
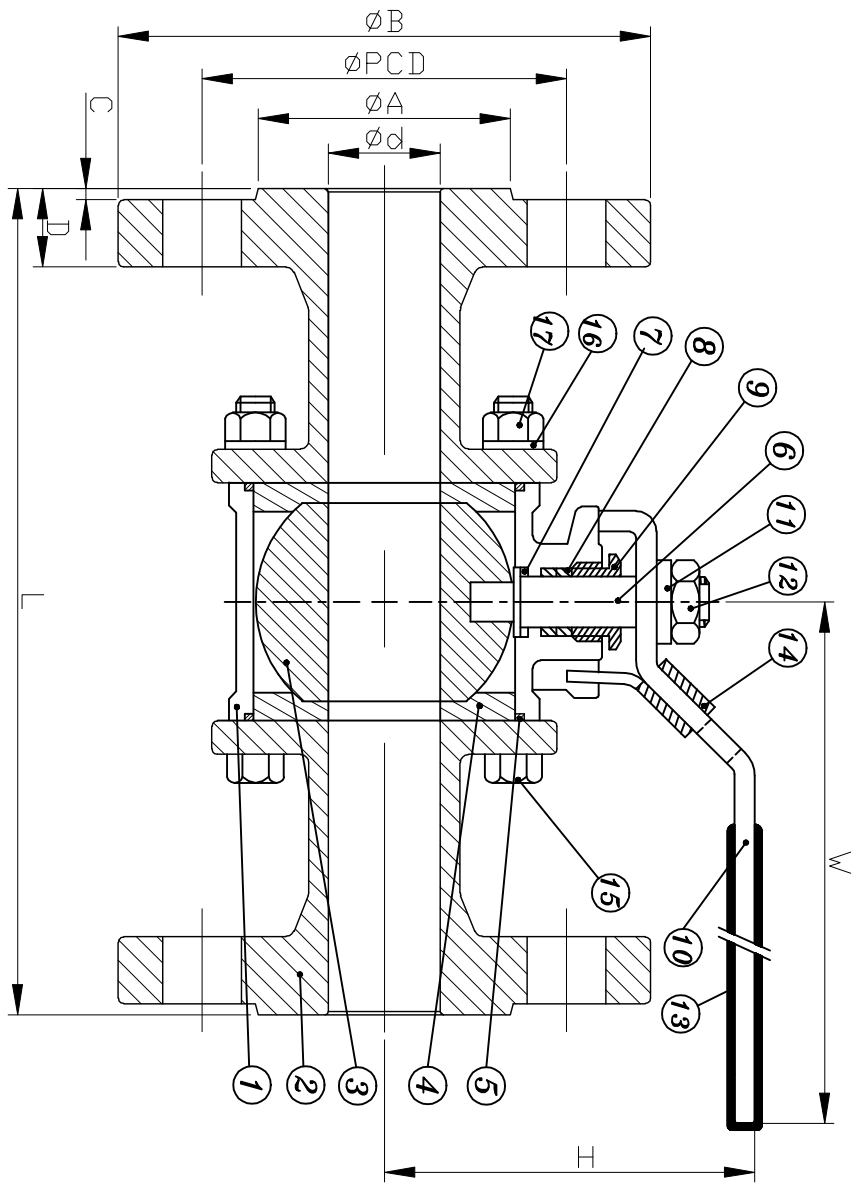

ITEM	PARTS	Q.TY	MATERIAL	
			V3E	V3E-C
1	BODY	1	ASTM-A351-CF8M	ASTM-A216-WCB
2	CAP	2	ASTM-A351-CF8M	ASTM-A216-WCB
3	BALL	1	ASTM-A351-CF8M	ASTM-A351-CF8
4	BALL SEAT	2	PTFE	PTFE
5	JOINT GASKET	2	PTFE	PTFE
6	STEM	1	AISI 316	AISI 316
7	THRUST WASHER	1	PTFE	PTFE
8	STEM PACKING	2	PTFE	PTFE
9	GLAND NUT	1	AISI 304	AISI 304
10	HANDLE	1	AISI 304	AISI 304
11	STEM WASHER	1	AISI 304	AISI 304
12	STEM NUT	1	AISI 304	AISI 304
13	PLASTIC COVER	1	PLASTIC	PLASTIC
14	LOCK DEVICE	1	AISI 304	AISI 304
15	BOLT	4-6	AISI 304	AISI 304
16	SPRING WASHER	4-12	AISI 304	AISI 304
17	HEX NUT	4-12	AISI 304	AISI 304

Valve-tek MFG. CO., LTD.

REV.	4
CHECKED	Morris
DESIGNER	Kevin
DRAWN	Kevin
DATE	2006/05/03
SCALE	Scaled to Fit
TYPE	V-3EF
DWG. NO.	VT_V3EF_001
DESCRIBE	3-PC FLANGED END FULL PORT BALL VALVE