

## V3-WC PN40 3-PC WAFER DISC CHECK VALVE

SIZE:DN15~DN100

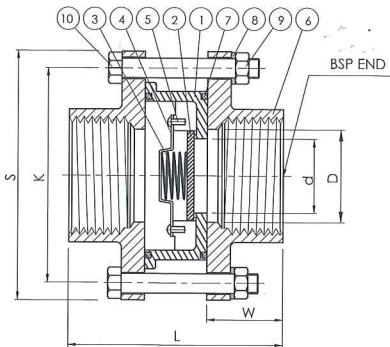

ITEM	PART	MATERIAL	Q.TY
1	VT-WC BODY	ASTM-A351-CF8M	1
2	DISC	ASTM-A351-CF8M	1
3	SPRING	ASTM-A351-CF8M	1
4	SPRING CAP	ASTM-A351-CF8M	1
5	SCREW	AISI 304	4
6	CAP	ASTM-A351-CF8M	2
7	JOINT GASKET	PTFE	2
8	SPRING WASHER	AISI 304	4
9	HEX NUT	AISI 304	4
10	BOLT	AISI 304	4

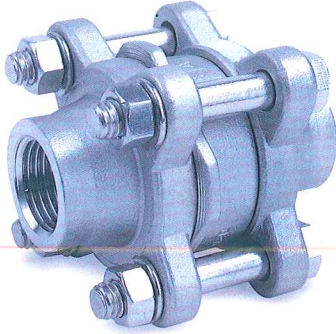
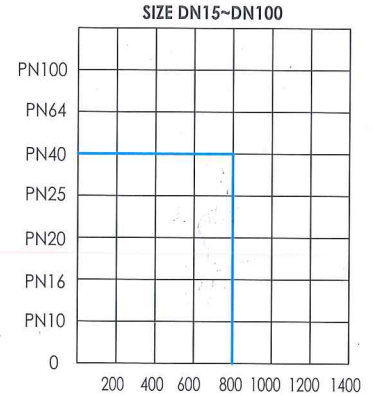

UNIT:MM

SIZE	DN	D	d	L	W	K	S	KGS
1/2"	15	15	15	67.5	25.4	55	71	0.65
3/4"	15	20	15	67.5	25.4	55	71	0.57
1"	20	25.4	20	75	27.8	63.5	80	0.77
1-1/4"	25	32	25	82.5	30	77	95.5	1.19
1-1/2"	32	38	30	98	35.3	87	106	1.64
2"	40	50.8	38	109	38.5	109	128	2.31
2-1/2"	65	65	62.5	140	47	136	163	5.06
3"	80	80	77	154	52.5	164	193	7.83
4"	100	100	96	195	68	206	241	15.74

## VT-WC PN40 1-PC WAFER DISC CHECK VALVE

SIZE:DN15~DN100

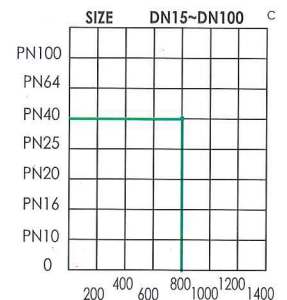
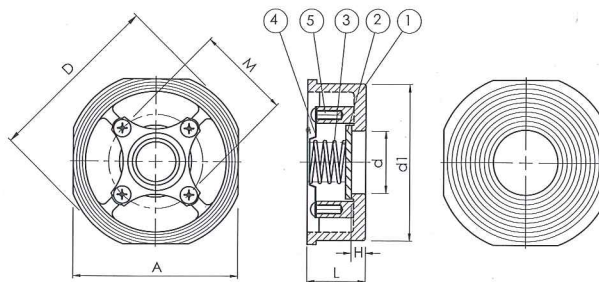

### FEATURES:

- \*Investment casting body
- \*Body in ASTM A351-CF8M
- \*Trim in AISI 316
- \*DISC in ASTM-A351-CF8M

### \* MATERIAL LIST \*

ITEM	PART	MATERIAL	Q.TY
1	BODY	ASTM-A351-CF8M	1
2	DISC	ASTM-A351-CF8M	1
3	SPRING	AISI 316	1
4	CAP	AISI 304	1
5	SCREW	AISI 304	4

UNIT:MM

DN	SIZE	d	d1	A	D	L	M	H	KGS WEIGHT
15	1/2"	15	43	45	53	16.5	27.7	4.4	0.12
20	3/4"	20	53	55	63	19.5	34.2	4.8	0.20
25	1"	25.4	63	65	73	22	39.4	5.4	0.30
32	1-1/4"	30	75	78	84	28	43.7	6.0	0.40
40	1-1/2"	38	86	88	94	32	54.0	6.6	0.60
50	2"	47	96	98	107	40	63.5	7.1	0.80
65	2-1/2"	62.5	115	118	126	46	82.8	7.8	1.50
80	3"	77	130	134	144	50	98.8	8.4	1.90
100	4"	96	151	154	164	60	119.8	9.0	3.30